

B12-B36

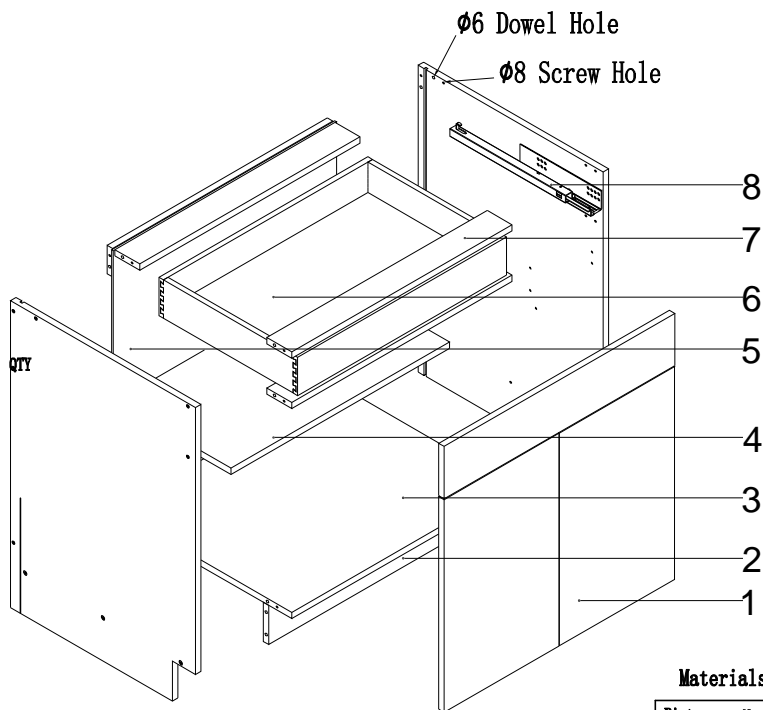
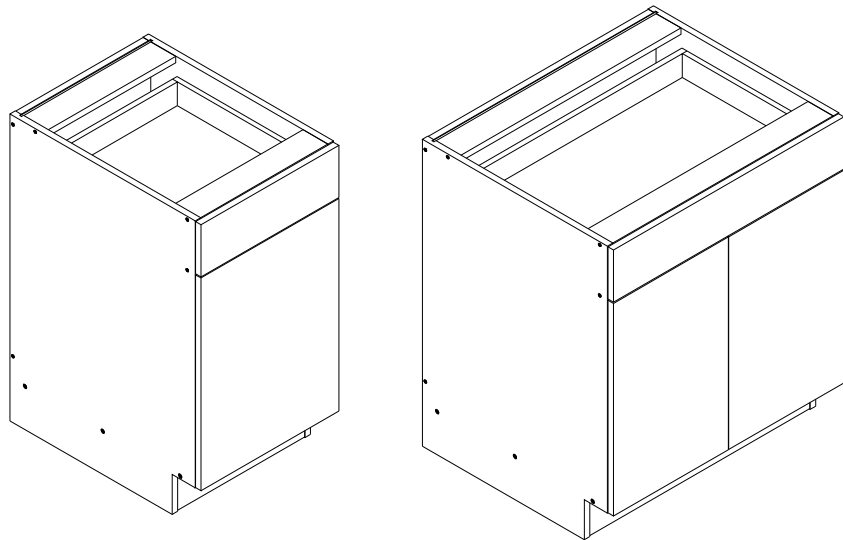

Materials List	
Picture	Name
	Screws
	Dowel
	Hinge
	Slider
1	Door
2	Kickboard
3	Bottom Panel
4	Shelf
5	Back Panel
6	Drawer box
7	Fixed Strip
8	Side Panel

STEP 1 Install the dowel into the side panels	STEP 3 Insert the strip and kickboard	STEP 5 Turn the screw into the screw hole	STEP 7 Install the slider
STEP 2 Keep a side panel flat on the floor, then insert bottom panel	STEP 4 Put another side panel	STEP 6 Insert the back panel	STEP 8 Drawer composition
Step 9 The drawer box accessible finished	STEP 11 Put the the drawer to the carcass cabinet.	STEP 13 Fix the hinge base one the side panel.	STEP 15 Press the hinges into the base, and then install doors.
Step 10 Install drawer front panel	STEP 12 Drawer accessible finished.	STEP 14 Install the hinge on the door.	STEP 16 Install the shelf support and shelf, accessible finished.

B09FHD-B39FHD

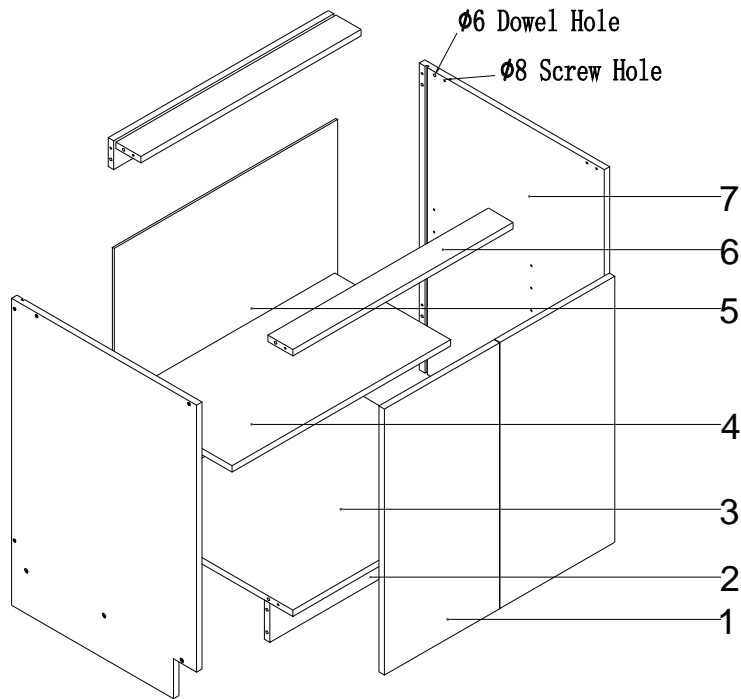
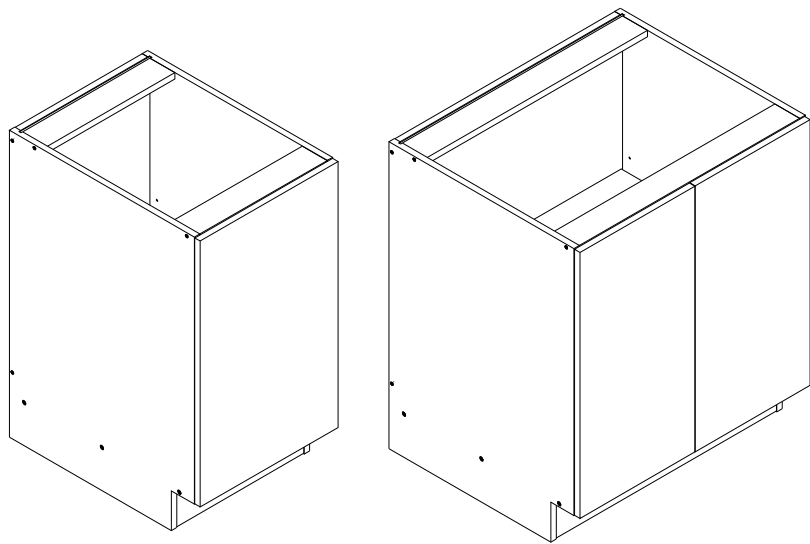

Materials List

Picture	Name
	Screws
	Dowel
	Hinge
1	Door
2	Kickboard
3	Bottom Panel
4	Shelf
5	Back Panel
6	Fixed Strip
7	Side Panel

STEP 1 Install the dowel into the side panels	STEP 3 Insert the strip and kickboard	STEP 5 Turn the screw into the screw hole	STEP 7 Fix the hinge base one the side panel.
STEP 2 Keep a side panel flat on the floor, then insert bottom panel	STEP 4 Put another side panel	STEP 6 Insert the back panel	STEP 8 Install the hinge on the door.
STEP 9 Press the hinges into the base, and then install doors.	STEP 10 Install the shelf support and shelf,accessibled finished		

DB24-2-DB36-2

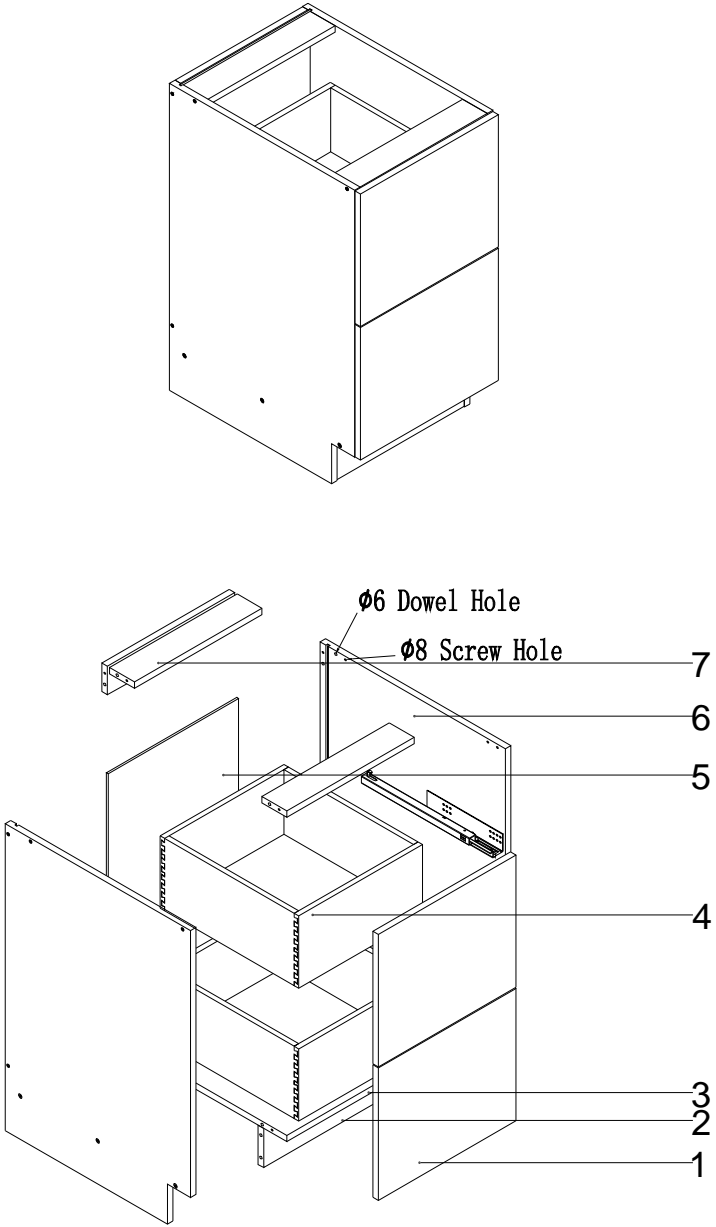

Materials List

Picture	Name
	Screws
	Dowel
	Slider
1	Door
2	Kickboard
3	Bottom Panel
4	Drawer box
5	Back Panel
6	Side Panel
7	Fixed Strip

STEP 1 Install the dowel into the side panels	STEP 3 Insert the strip and kickboard	STEP 5 Turn the screw into the screw hole	STEP 7 Install the slider
STEP 2 Keep a side panel flat on the floor, then insert bottom panel	STEP 4 Put another side panel	STEP 6 Insert the back panel	STEP 8 Drawer composition
Step 9 The drawer box accessible finished	STEP 11 Put the the drawer to the carcass cabinet.		
Step 10 Install drawer front panel	STEP 12 Accessible Finished.		

DB12-3-DB36-3

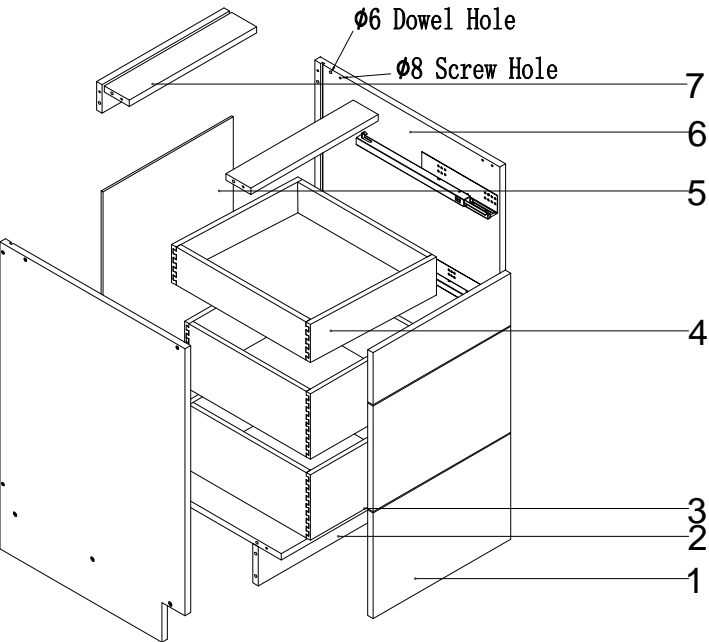
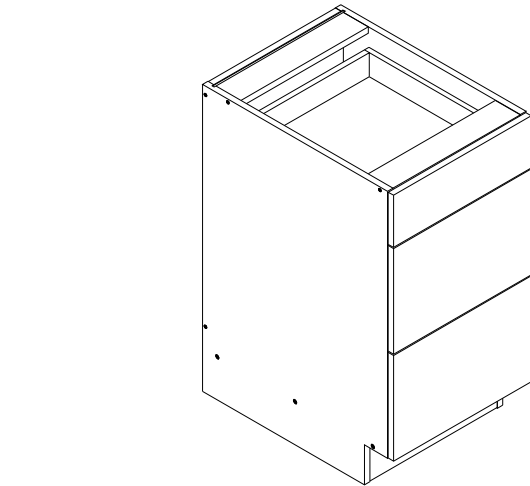

Materials List

Picture	Name
	Screws
	Dowel
	Slider
1	Door
2	Kickboard
3	Bottom Panel
4	Drawer box
5	Back Panel
6	Side Panel
7	Fixed Strip

STEP 1 Install the dowel into the side panels	STEP 3 Insert the strip and kickboard	STEP 5 Turn the screw into the screw hole	STEP 7 Install the slider
STEP 2 Keep a side panel flat on the floor, then insert bottom panel	STEP 4 Put another side panel	STEP 6 Insert the back panel	STEP 8 Drawer composition
Step 9 The drawer box accessible finished	STEP 11 Put the the drawer to the carcass cabinet.		
Step 10 Install drawer front panel	STEP 12 Accessible Finished.		

SB24-SB36

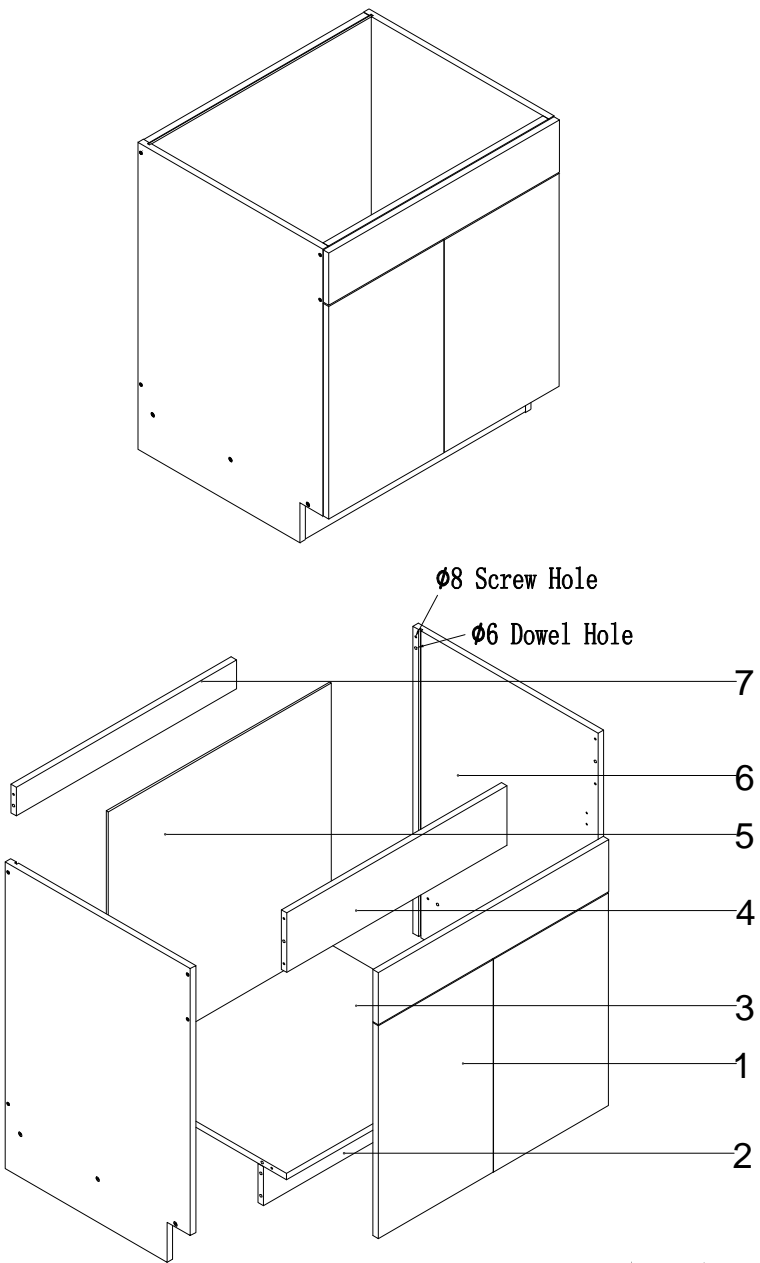

Materials List	
Picture	Name
	Screws
	Dowel
	Hinge
1	Door
2	Kickboard
3	Bottom Panel
4	Filler
5	Back Panel
6	Side Panel
7	Fixed Strip

STEP 1 Install the dowel into the side panels	STEP 3 Insert the strip and kickboard	STEP 5 Turn the screw into the screw hole	STEP 7 Install false drawer panel.
STEP 2 Keep a side panel flat on the floor, then insert bottom panel	STEP 4 Put another side panel	STEP 6 Insert the back panel.	STEP 8 Fix the hinge base one the side panel.
STEP 9 Install the hinge on the door.	STEP 11 Accessible Finished.		
STEP 10 Press the hinges into the base, and then install doors.			

FSB33/FSB36

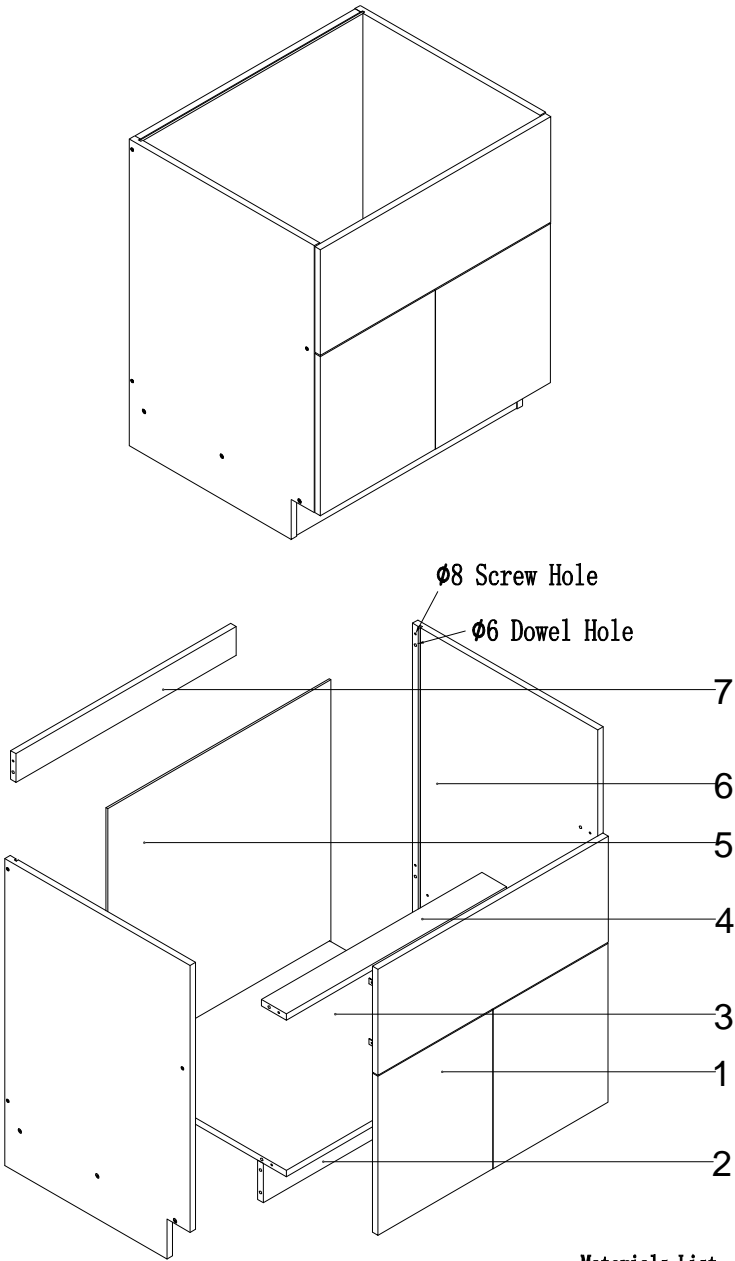

Materials List	
Picture	Name
	Screws
	Dowel
	Hinge
1	Door
2	Kickboard
3	Bottom Panel
4	Filler
5	Back Panel
6	Side Panel
7	Fixed Strip

STEP 1 Install the dowel into the side panels	STEP 3 Insert the strip and kickboard	STEP 5 Turn the screw into the screw hole	STEP 7 Install false drawer panel.,fixed with a corner code.
STEP 2 Keep a side panel flat on the floor, then insert bottom panel	STEP 4 Put another side panel	STEP 6 Insert the back panel.	STEP 8 Accessibled Finished.
STEP 9 Fix the hinge base one the side panel.	STEP 11 Press the hinges into the base, and then install doors.		
STEP 10 Install the hinge on the door.	STEP 12 Accessibled Finished.		

BM30

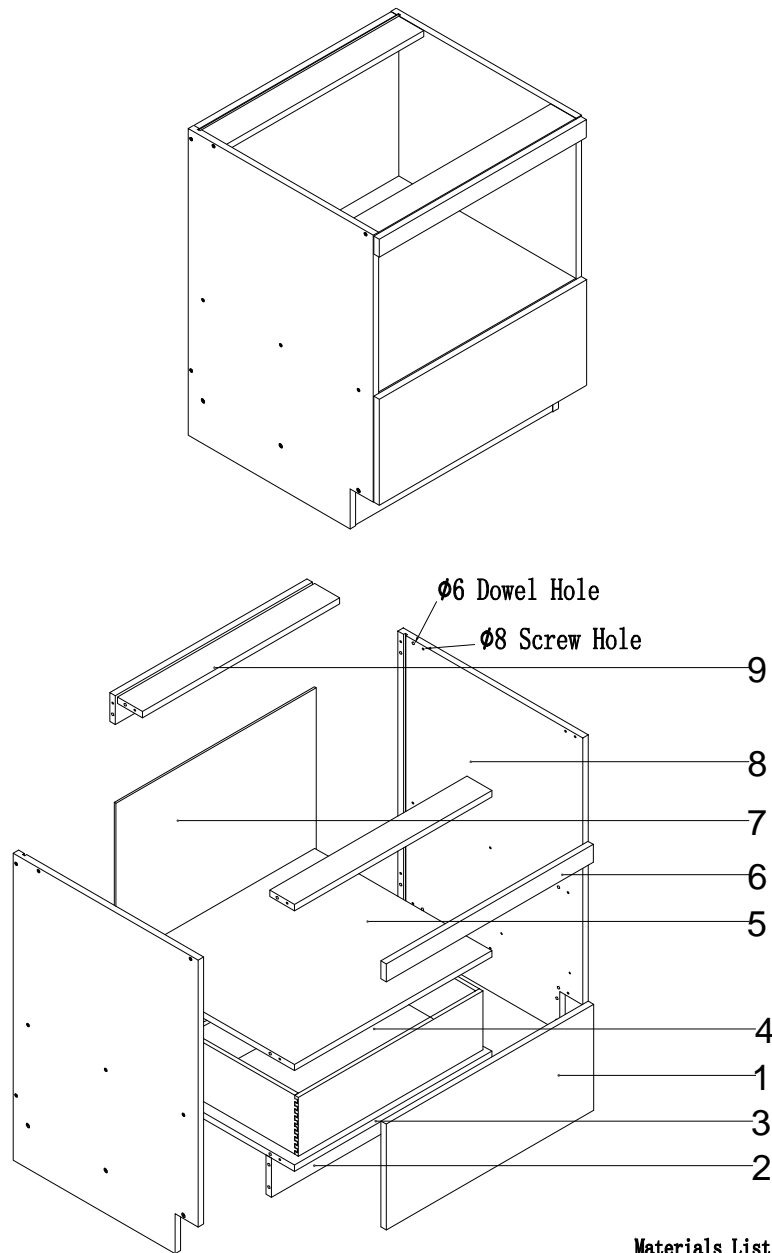

Materials List

Picture	Name
	Screws
	Dowel
	Slider
	1 Door
	2 Kickboard
	3 Bottom Panel
	4 Drawer box
	5 Fixed Shelf
	6 Filler
	7 Back Panel
	8 Side Panel
	9 Fixed Strip

STEP 1 Install the dowel into the side panels	STEP 3 Insert the strip and kickboard	STEP 5 Turn the screw into the screw hole	STEP 7 Install the slider
STEP 2 Keep a side panel flat on the floor, then insert bottom panel	STEP 4 Put another side panel	STEP 6 Insert the back panel.	STEP 8 Drawer composition
Step 9 The drawer box accessible finished	STEP 11 Put the the drawer to the carcass cabinet.		
Step 10 Install drawer front panel	STEP 12 Accessible Finished.		

BBC36
BBC39
BBC42

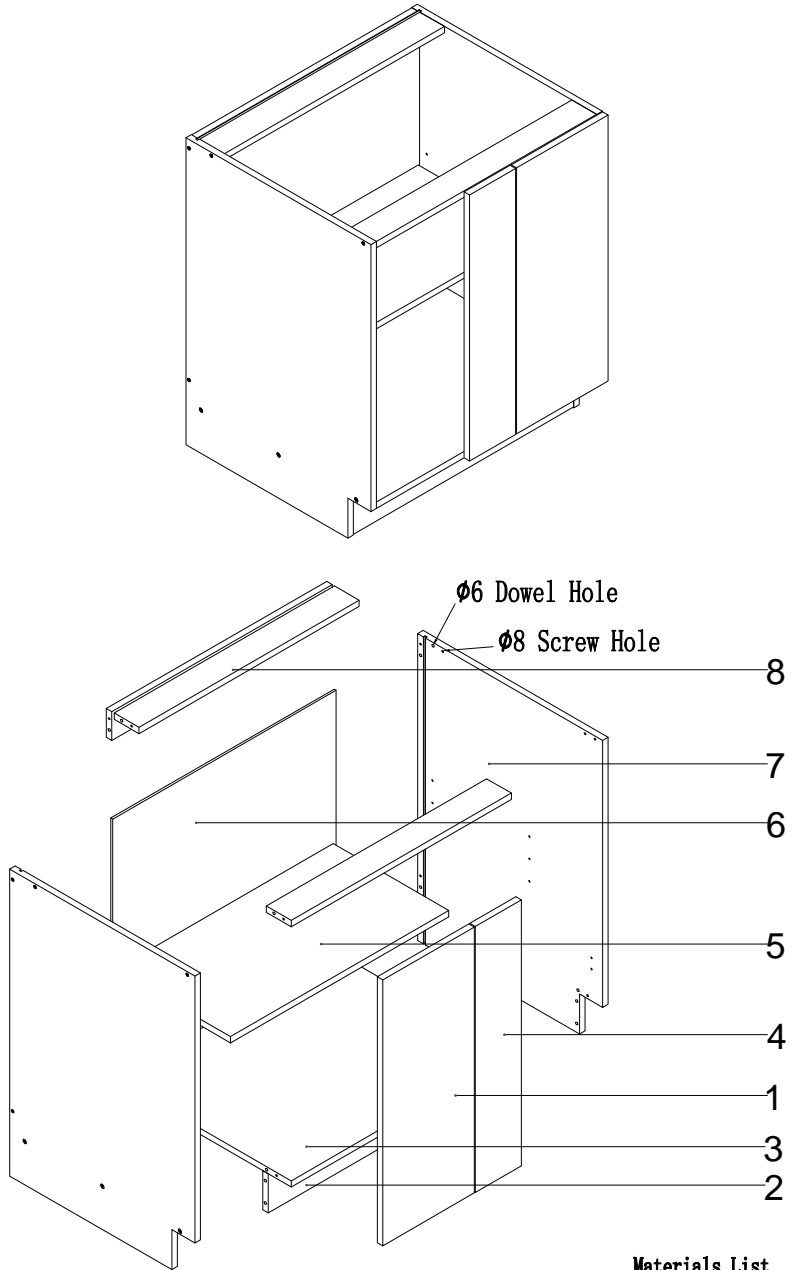

Materials List

Picture	Name
	Screws
	Dowel
	Hinge
1	Door
2	Kickboard
3	Bottom Panel
4	Filler
5	Shelf
6	Back Panel
7	Side Panel
8	Fixed Strip

STEP 1 Install the dowel into the side panels	STEP 3 Insert the strip and kickboard	STEP 5 Turn the screw into the screw hole	STEP 7 Install fixed sealing plates with corner codes
STEP 2 Keep a side panel flat on the floor, then insert bottom panel	STEP 4 Put another side panel	STEP 6 Insert the back panel.	STEP 8 Install the hinge on the door.
STEP 9 Press the hinges into the base, and then install doors.	STEP 11 Accessible Finished.		
STEP 10 Install the shelf support and shelf.			

BER33/BER36

STEP 1 Install the dowel into the side panels.

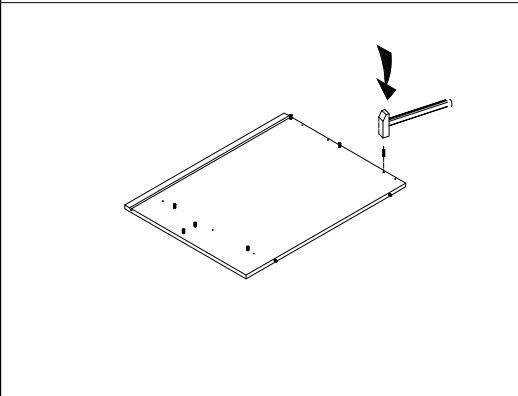

STEP 3 Insert the front side panel

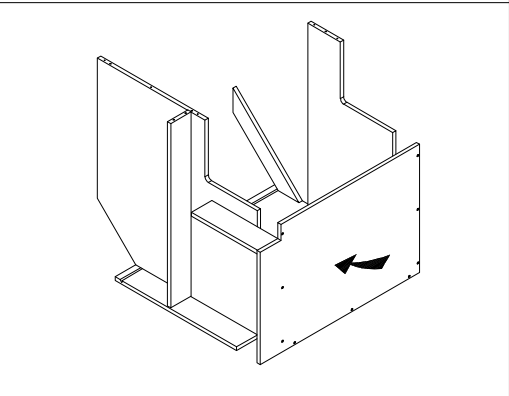

STEP 5 Put another front side panel.

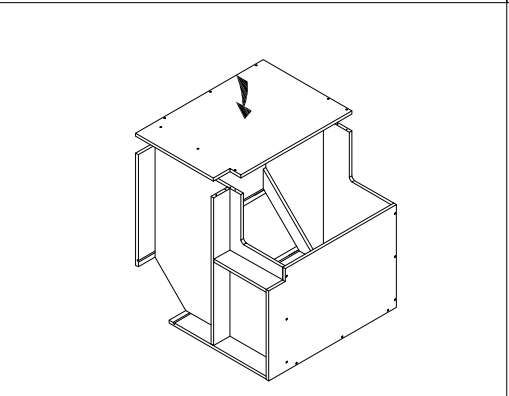

STEP 7 Turn the screw into the screw hole

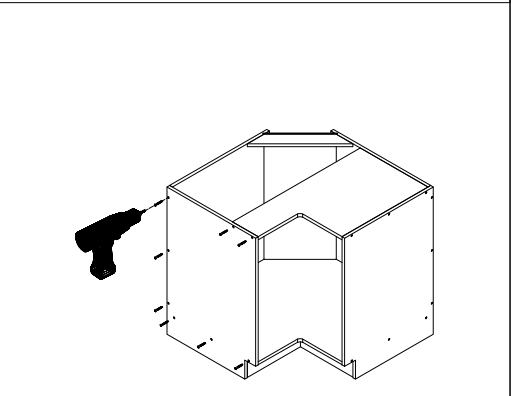

STEP 2 Keep a side panel flat on the floor, then insert top and bottom panel .

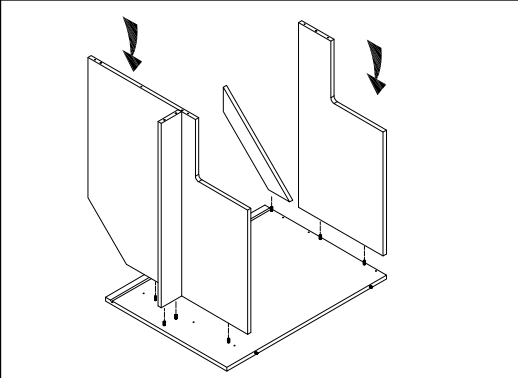

STEP 4 Put another back side panel.

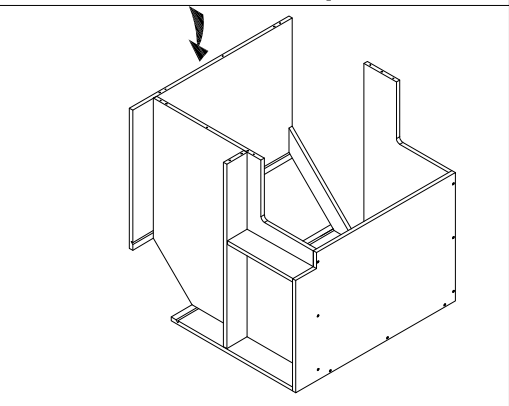

STEP 6 Insert the back panel.

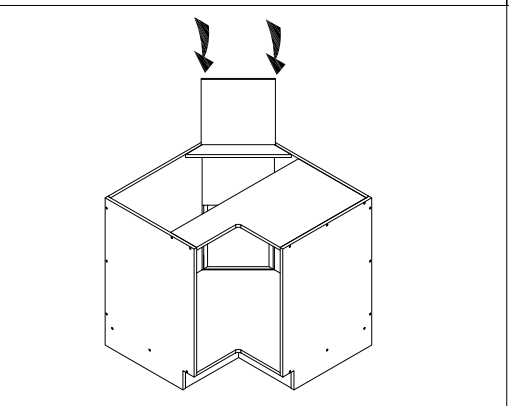

STEP 8 Install the hinge on the door.

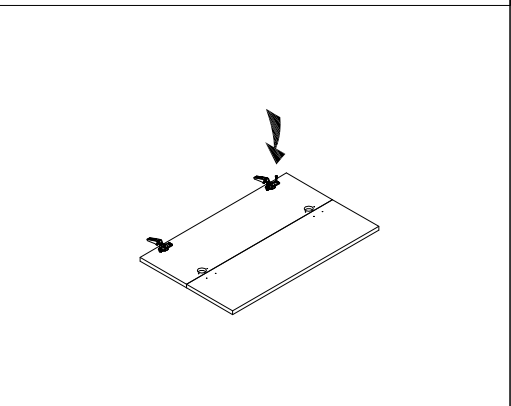

STEP 9 Install the shelf support and shelf.

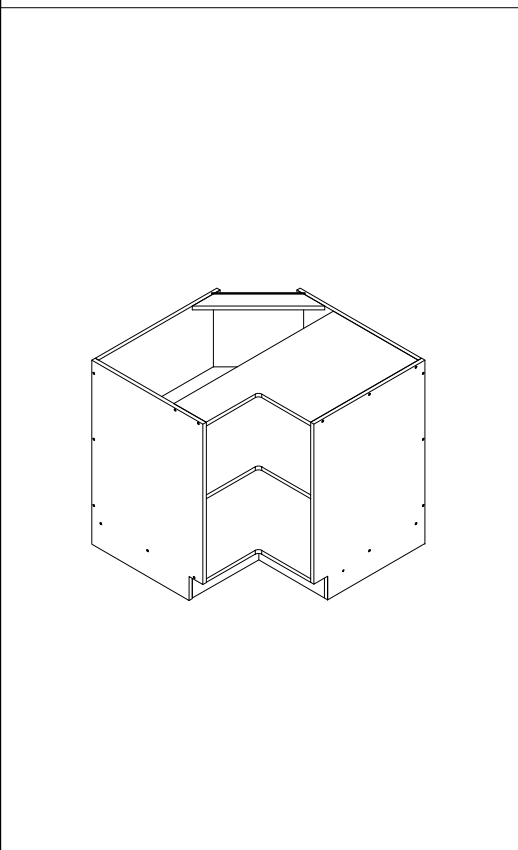

STEP 10 Press the hinges into the base, and then install doors.Accessible finished.

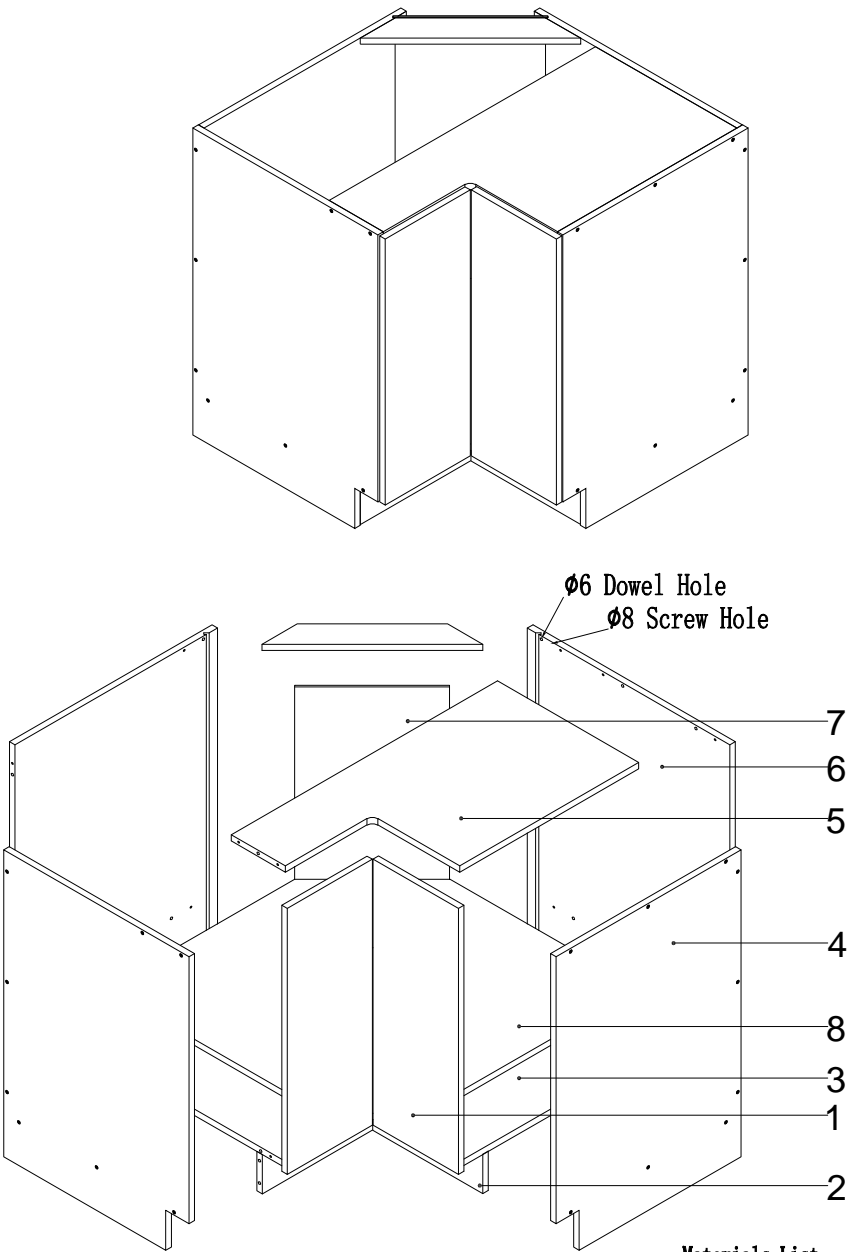
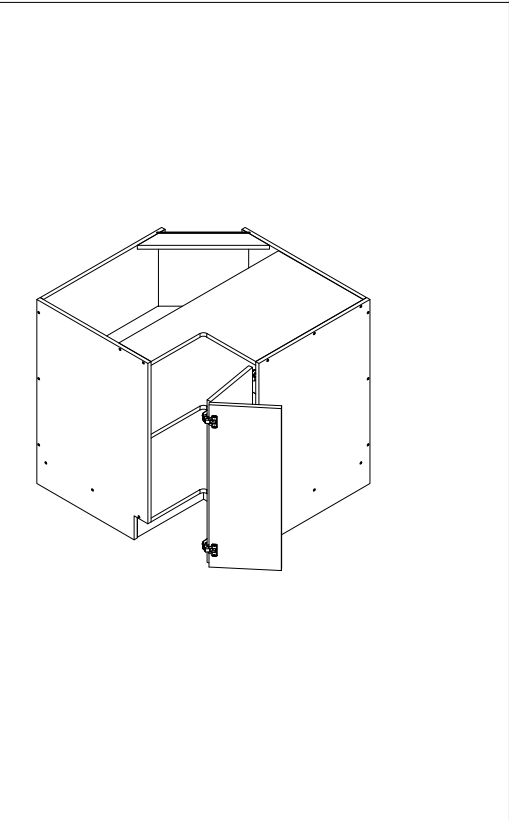

Materials List

Picture	Name
	Screws
	Dowel
	Hinge
1	Door
2	Kickboard
3	Bottom Panel
4	Front Side Panel
5	Top Panel
6	Back Side Panel
7	Back Panel

BSP09S

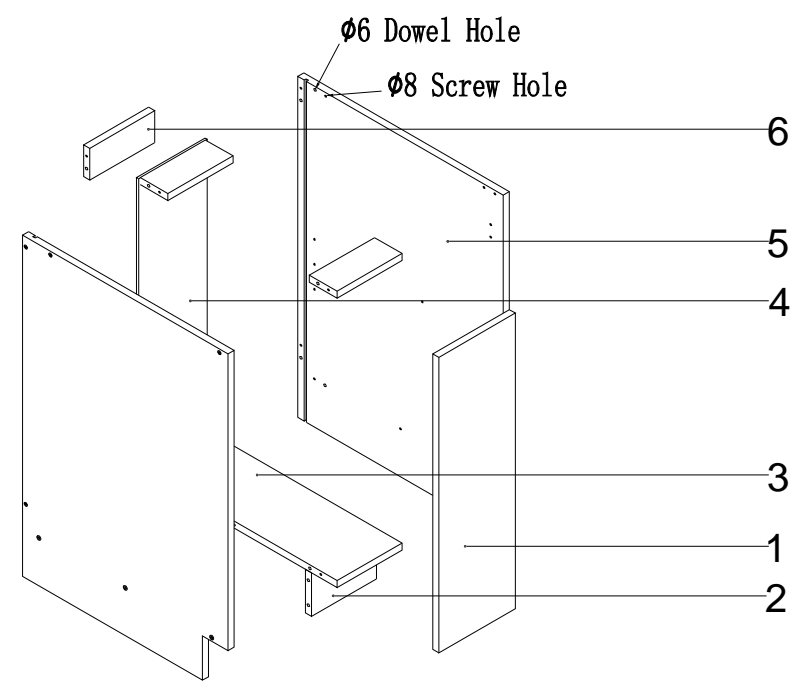
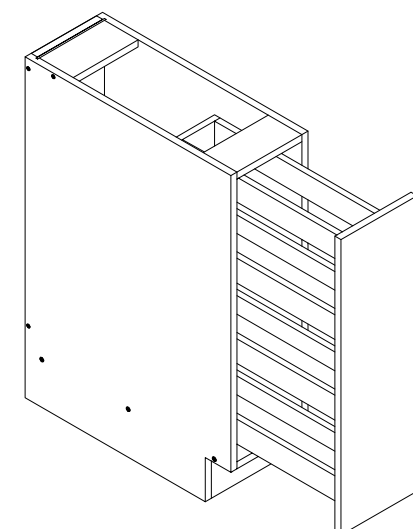

Materials List

Picture	Name
	Screws
	Dowel
1	Door
2	Kickboard
3	Bottom Panel
4	Back Panel
5	Side Panel
6	Fixed Strip

STEP 1 Install the dowel into the side panels	STEP 3 Insert the strip and kickboard
STEP 2 Keep a side panel flat on the floor, then insert bottom panel	STEP 4 Put another side panel
STEP 5 Turn the screw into the screw hole	STEP 7 Install the seasoning basket/trash can, Accessible Finished.
STEP 6 Insert the back panel.	

BWBK18-2A

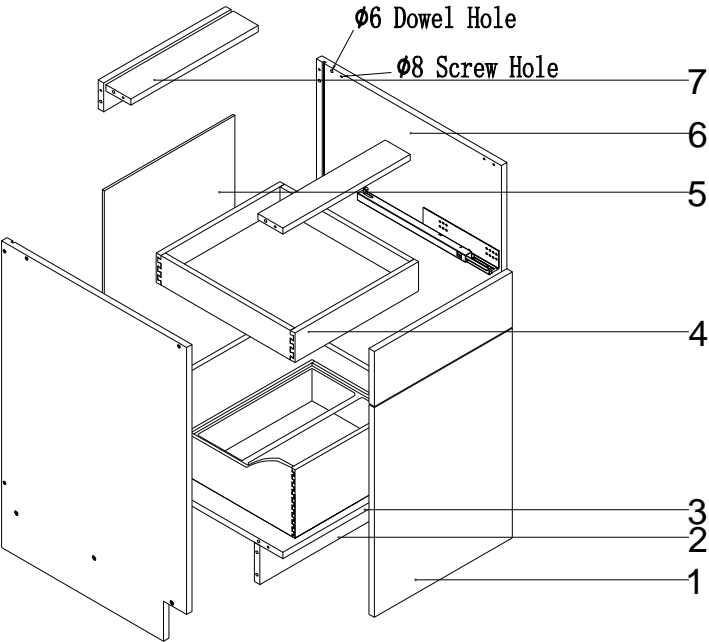
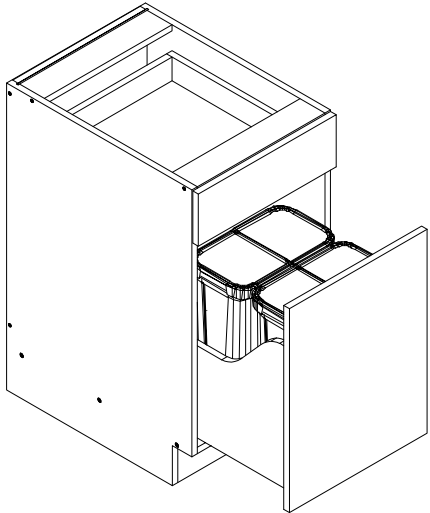

Materials List

Picture	Name
	Screws
	Dowel
	Slider
	Door
	Kickboard
	Bottom Panel
	Drawer box
	Back Panel
	Side Panel
	Fixed Strip

STEP 1 Install the dowel into the side panels		STEP 3 Insert the strip and kickboard	STEP 5 Turn the screw into the screw hole	STEP 7 Install the slider
STEP 2 Keep a side panel flat on the floor, then insert bottom panel		STEP 4 Put another side panel	STEP 6 Insert the back panel	STEP 8 Drawer composition
Step 9 The drawer box accessible finished		STEP 11 Put the the drawer to the carcass cabinet.		
Step 10 Install drawer front panel		STEP 12 Accessible Finished.		